

Hand-Hold Electric Winch

HDW500 HDW1000



Your safety and the safety of others is very important. To help you make informed decisions about safety. We have provided installation and operating instructions and other information on labels and in this guide. This information alerts you to potential hazards that could hurt you or others. Careless product installation and operation can result in serious injury or equipment damage. Read and understand all safety precautions and operating instructions before installing and operating this product.

TECHNICAL DATA

Model	HDW500	HDW1000
Voltage	12V DC	24V DC
Current	25A	25A
Input power	300W	600W
No load speed	(0-1.0 m/min Variable)	
Capacity	500 Lbs (227 Kgs)	1000 Lbs (454 Kgs)
Wire rope (Dia. xL)	0.22"×15' (5.6mm×4.6m)	0.22"×15' (5.6mm×4.6m)

PARTS BRIEF

- ① Hook
- ② Speed Setting Controller
- ③ Reversing Switch
- ④ Power Switch
- ⑤ Rope Back Plate
- ⑥ Power Cord

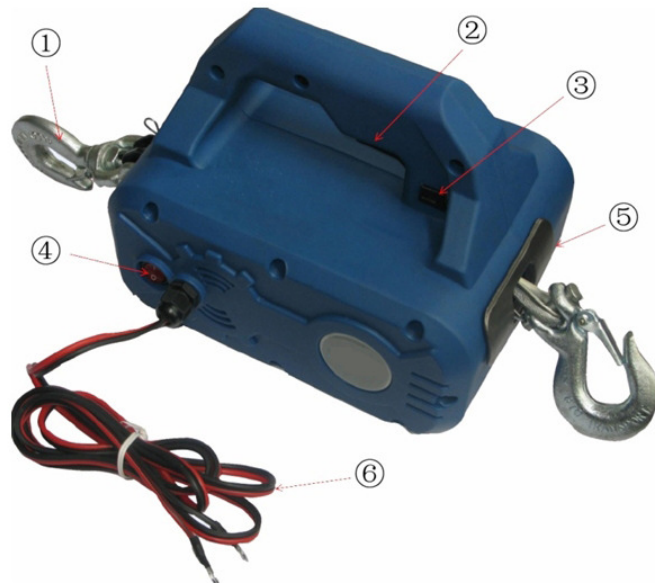

GENERAL

The HDW type—hand-hold electric winch by the 12V or 24V DC as a power source (Reference Technical Data) , protection from incorrect connection of battery poles, Use safe and reliable. (The black power cord is for negative pole (－) , and the red power cord is positive pole (+) . (See: Circuit Diagram)

SAFETY INSTRUCTIONS

1. Failure to observe these instructions could lead to severe injury or death.
2. To avoid injury to hands or fingers, Always keep hands clear of wire rope, hook and fairlead opening during installation, operation and when spooling in or out.
3. Always use extreme caution when handling hook and wire rope during spooling operations.
4. Always wear eye protection.
5. Always insulate and protect all exposed wiring and electrical terminals.
6. Never put relay in to fire or expose to high heat, this may cause relay to explode.
7. Do not pull cord to disconnect the plug. Keep cord from heat, oil and sharp edges.
8. Do not try to lift fixed or obstructed loads.
9. Pull out the power splicing when not in use.
10. Factory configuration of the power cord length is 1.8m, if extension the power cord, Must Increase the conductor cross-section to the appropriate size.
11. Inspect the electric winch regularly; check the switches are in good operating conditions.
12. Avoid switch-on / switch-off quickly sequences.
13. Not allow your attention to be diverted from operating the electric winch.
14. When drinking, drugs, illness, and danger of external conditions, do not operating electric winch.

INSTALLATION & USE

Unpacking

After opening the carton, carefully inspect the winch shell, power cable, hooks and control switch for damage that may have occurred during shipment.

Hook Assembly

The electric winch is equipped with the hook assembly mounted on the shrink-ring of rope which is inside of rope back plate. (See Pictures)



OPERATING INSTRUCTIONS

1. Always check that the voltage corresponds to the voltage on the rating plate. In case the mains voltage is not suitable may cause working abnormally or personal injury.
2. Always choose a support structure and load attaching devices that is sufficiently strong to withstand the maximum pulling capacity of your product.
3. Always inspect rope, hooks, and slings before operating product. Damaged components and rigging must be replaced immediately. Protect all parts from damage.
4. It is forbidden to lift loads above the rated load of the electric winch.
5. Never swing or twist loads.
6. Use the device only for its intended purpose. Never use to lift or move persons.
7. Keep children and other unauthorized persons away from the machine.
8. Have your tool repaired by an expert; otherwise it may cause danger for the user.
9. Never leave suspended load unattended.
10. Do not empty-handed on a wire slide.
11. Always wear leather gloves when Operating the winch and handling wire rope.
12. Always ensure hook travels in the same direction as directional switch indicates.
13. Never use the product to tow other vehicles. Shock loads can momentarily exceed capacity of wire rope and product.
14. Always stand to the side of the product during operation.
15. Always be aware of stability of load during operation.
16. Never touch wire rope or hook while in tension or under load.

PERIODIC INSPECTION & MAINTENANCE

Attention! Always make sure that the machine is not connected to the mains electricity when you carry out any maintenance of the mechanism.

1. Hereinafter, per cycle means that the operator operates the load up and down one time. Periodically checking usually means it has checked after the electric winch work per 100 cycles.
2. Periodically check power cord and operation buttons.
3. Per 200 cycles may lubricate the steel cable.
4. Per 30 cycles check that the entire steel cable is in good condition. If the cable is damaged. Replace the cable immediately according to the technical data form. (See Pictures)

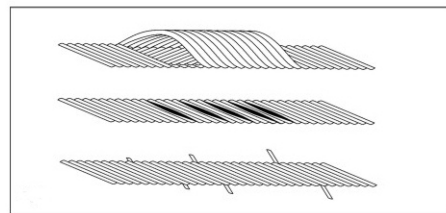

5. Per 1000 cycles check that the Hook, Pin and Split Cotter Pin are well tightened.
6. Check that the speed setting controller, Reversing switch and power switch are in good operating conditions before every using the electric winch.
7. Per 1000 cycles check brake function system. If motor with abnormal noise, or electric winch without hold the rated load, the brake function system may have some overhaul.
8. Replace damaged or worn parts, and keep appropriate records of maintenance.
9. For extraordinary maintenance contact an authorized service center.

CIRCUIT DIAGRAM:

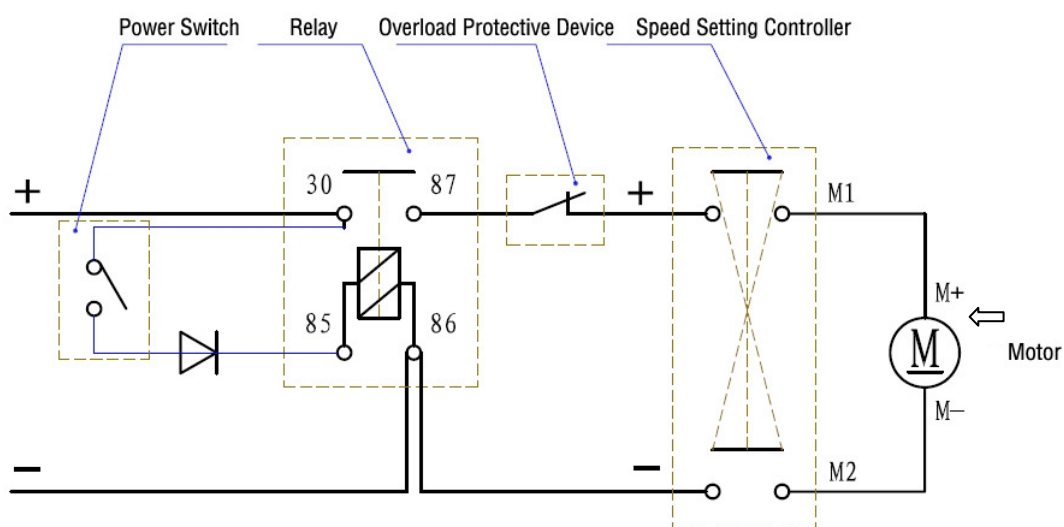

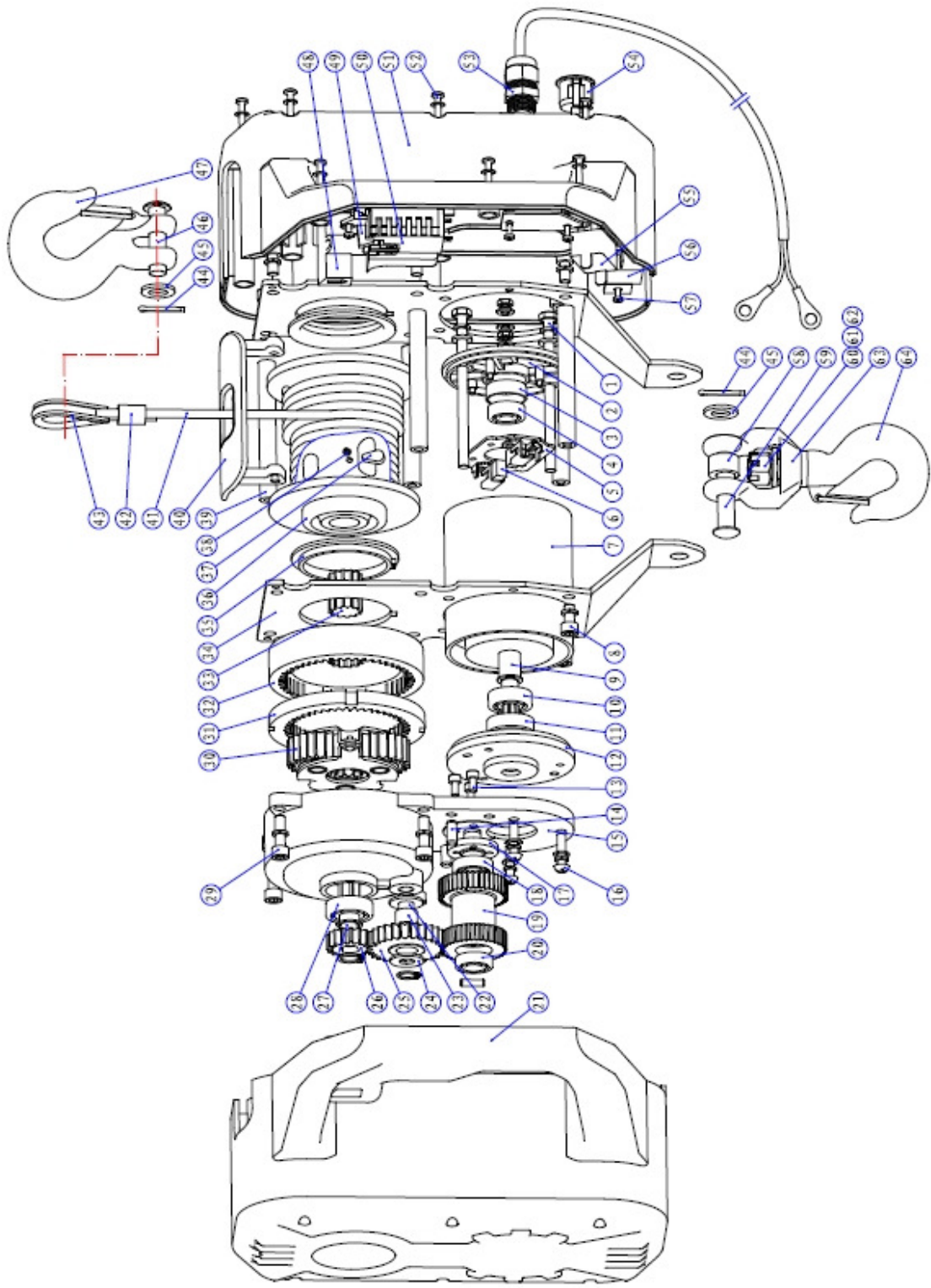

Parts List

NO.	Name	Qty.	NO.	Name	Qty.
1	Hex Head Bolts (6X95)	2	33	Spline Shaft	1
2	Gear Cover (Back)	1	34	Support Plate	2
3	Bearing Sleeve (small)	1	35	Washer	2
4	Bearing (608-2Z)	1	36	Rope Tube	1
5	Brush Carrier	1	37	Drill Key	1
6	Carbon Brush	2	38	Hex Screw (M4X4)	1
7	Stator	1	39	Anchor Post	5
8	Hex Socket Screw (M6X12)	8	40	Rope Back Plate	1
9	Rotor	1	41	Rope	4.6m
10	Bearing (6000-2Z)	1	42	Fastening Sleeve Of Rope	1
11	Bearing Sleeve	1	43	Shrink-Ring Of Ropr	1
12	Front Cover	1	44	Split Cotter Pin (2.5X20)	2
13	Hex Socket Screw (M4X8)	3	45	Plain Washer (d10)	2
14	Pin (6X14)	2	46	Pin	1
15	Gear Box	1	47	Hook	1
16	Cruciform Slot Screw(M5X20)	3	48	Changeover Button	1
17	Duplicate Gear Shaft	1	49	Switch Press Plate	1
18	Bearing (61901-2RS)	1	50	Speed Setting controller	1
19	Duplicate Gear	1	51	Right Shell	1
20	Bearing (61900-2RS)	1	52	Cross Recessed Pan Head Tapping Screw	10
21	Left Shell	1	53	Gland(M16)	1
22	2 Gear Shaft	1	54	Power Switch	1
23	Multi-Roll Bearing	1	55	Over load Protective Device	1
24	Plain Washer	2	56	Relay	1
25	GRADE 2 GEAR	1	57	Cross Recessed Pan Head Tapping Screw	4
26	GRADE 3 GEAR	1	58	Backing Ring	1
27	Sun Wheel	1	59	Pin	1
28	Bearing (6001-2RS)	1	60	Hexagon Thin Slotted And Castle Nut(M12)	1
29	Hex Socket Screw (M6X20)	4	61	Plain Washer (d12)	1
30	Planetary Gear Set	1	62	Pin	1
31	Fixed Ring Gear	1	63	U-fastener	1
32	Output Gear	1	64	Hook	1